

SERVICE OFFSET TABLE

Location	Gas		ND - Water		Water		Electricity		Telecommunication		Sewer	
	Side	Offset (m)	Side	Offset (m)	Side	Offset (m)	Side	Offset (m)	Side	Offset (m)	Side	Offset (m)
MARRIOTT BOULEVARD	N	2.10	-	-	N	2.60	S	2.60	S	1.90	N	1.00
STUDLEY STREET	W	2.05 / 2.10	W	2.55	W	3.05 / 2.60	E	2.60	E	1.90	Ex. W	Ex. 1.00

NOTE: STREET TREES ARE TO BE PLANTED IN THE CENTRE OF ALL NATURE STRIPS

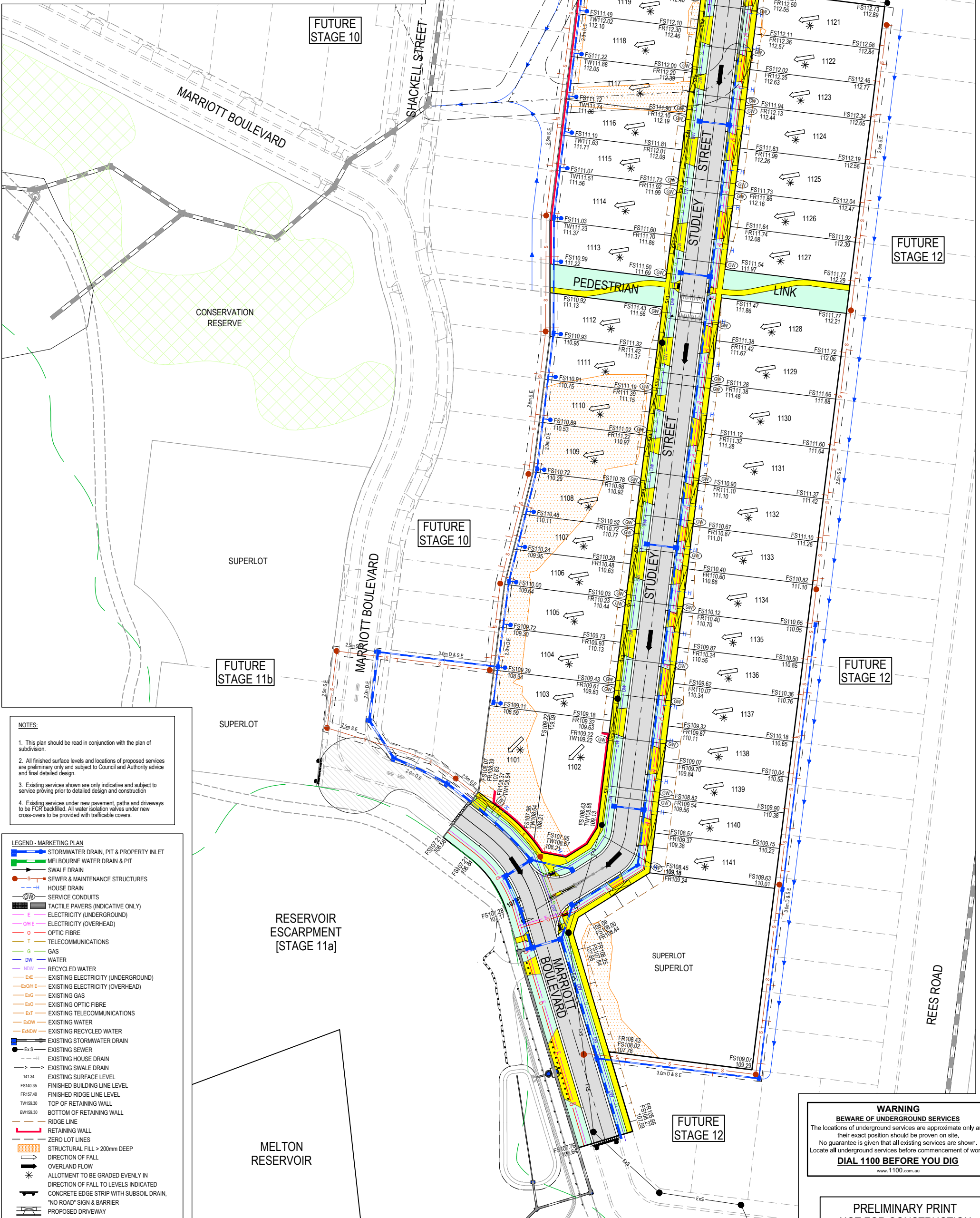

- NOTES:**
- This plan should be read in conjunction with the plan of subdivision.
 - All finished surface levels and locations of proposed services are preliminary only and subject to Council and Authority advice and final detailed design.
 - Existing services shown are only indicative and subject to service proving prior to detailed design and construction.
 - Existing services under new pavement, paths and driveways to be FCR backfilled. All water isolation valves under new cross-overs to be provided with trafficable covers.

- LEGEND - MARKETING PLAN**
- STORMWATER DRAIN, PIT & PROPERTY INLET
 - MELBOURNE WATER DRAIN & PIT
 - SWALE DRAIN
 - SEWER & MAINTENANCE STRUCTURES
 - HOUSE DRAIN
 - SERVICE CONDUITS
 - TACTILE PAVERS (INDICATIVE ONLY)
 - ELECTRICITY (UNDERGROUND)
 - ELECTRICITY (OVERHEAD)
 - OPTIC FIBRE
 - TELECOMMUNICATIONS
 - GAS
 - WATER
 - RECYCLED WATER
 - EXISTING ELECTRICITY (UNDERGROUND)
 - EXISTING ELECTRICITY (OVERHEAD)
 - EXISTING GAS
 - EXISTING OPTIC FIBRE
 - EXISTING TELECOMMUNICATIONS
 - EXISTING WATER
 - EXISTING RECYCLED WATER
 - EXISTING STORMWATER DRAIN
 - EXISTING SEWER
 - EXISTING HOUSE DRAIN
 - EXISTING SWALE DRAIN
 - EXISTING SURFACE LEVEL
 - FINISHED BUILDING LINE LEVEL
 - FINISHED RIDGE LINE LEVEL
 - TOP OF RETAINING WALL
 - BOTTOM OF RETAINING WALL
 - RIDGE LINE
 - RETAINING WALL
 - ZERO LOT LINES
 - STRUCTURAL FILL > 200mm DEEP
 - DIRECTION OF FLOW
 - OVERLAND FLOW
 - ALLOTMENT TO BE GRADED EVENLY IN DIRECTION OF FALL TO LEVELS INDICATED
 - CONCRETE EDGE STRIP WITH SUBSOIL DRAIN
 - "NO ROAD" SIGN & BARRIER
 - PROPOSED DRIVEWAY

WARNING
BEWARE OF UNDERGROUND SERVICES
 The locations of underground services are approximate only and their exact position should be proven on site. No guarantee is given that all existing services are shown. Locate all underground services before commencement of works
DIAL 1100 BEFORE YOU DIG
 www.1100.com.au

PRELIMINARY PRINT
NOT FOR CONSTRUCTION

REV	DESCRIPTION	DATE	DRN.	APP.
P3	UPDATED AS PER IFC DESIGN	21.03.18	S.M.	P.D.
P2	UPDATED STAGE BOUNDARY, INCL. SUPERLOT	12.12.17	S.M.	P.D.
P1	ISSUED FOR INFORMATION	16.10.17	S.M.	P.D.

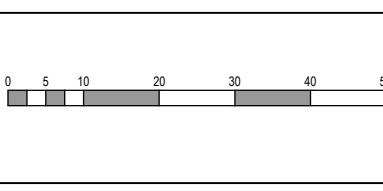

Designed Date: S.McDONALD 20.09.17
 Drawn: S.McDONALD
 Approved Date: P.DAVY 16.10.17
 PS Number: PS811548C

BW Beveridge Williams
 development & environment consultants
 1 Glenferrie Road
 Malvern VIC 3144
 ph: 03 9524 8888
 www.beveridgewilliams.com.au

Project Details: **TOOLERN WATERS ESTATE**
STAGE 11
CITY OF MELTON
 Drawing Title: **MARKETING PLAN**

Sheet 01 of 02			
Scale	1:500 @ A1		
Project Ref	Stage No	Drawing No	Rev
1600490	11	-	P3

K:\Jobs Data\1600490 - Toolern Waters - Melton South_Eng\Stage 11 Drawings\1600490-11-M.plt