

- LEGEND - LAYOUT PLAN**
- STORMWATER DRAIN, PIT & PROPERTY INLET
 - MELBOURNE WATER DRAIN & PIT
 - SWALE DRAIN
 - SEWER & MAINTENANCE STRUCTURES
 - HOUSE DRAIN
 - SERVICE CONDUITS
 - TACTILE PAVERS (INDICATIVE ONLY)
 - ELECTRICITY (UNDERGROUND)
 - ELECTRICITY (OVERHEAD)
 - OPTIC FIBRE
 - TELECOMMUNICATIONS
 - GAS
 - WATER
 - RECYCLED WATER
 - EXISTING ELECTRICITY (UNDERGROUND)
 - EXISTING ELECTRICITY (OVERHEAD)
 - EXISTING GAS
 - EXISTING OPTIC FIBRE
 - EXISTING TELECOMMUNICATIONS
 - EXISTING WATER
 - EXISTING RECYCLED WATER
 - EXISTING STORMWATER DRAIN
 - EXISTING SEWER
 - EXISTING HOUSE DRAIN
 - EXISTING SURFACE LEVEL
 - EXISTING SWALE DRAIN
 - EXISTING SURFACE LEVEL
 - FINISHED BUILDING LINE LEVEL
 - FINISHED RIDGE LINE LEVEL
 - TOP OF RETAINING WALL
 - BOTTOM OF RETAINING WALL
 - RIDGE LINE
 - RETAINING WALL
 - ZERO LOT LINES
 - PAVEMENT TREATMENT
 - STRUCTURAL FILL > 200mm DEEP
 - EX. STRUCTURAL FILL > 200mm DEEP
 - DIRECTION OF FALL
 - OVERLAND FLOW
 - ALLOTMENT TO BE GRADED EVENLY IN DIRECTION OF FALL TO LEVELS INDICATED
 - CONCRETE EDGE STRIP WITH SUBSOIL DRAIN, 'NO ROAD' SIGN & BARRIER
 - LIMIT OF WORKS
 - EXISTING TREE TO BE REMOVED
 - PERMANENT SURVEY MARK
 - TEMPORARY BENCH MARK
 - PROPOSED DRIVEWAY
 - TREE PROTECTION ZONE (TPZ)

BEWARE
AusNet Transmission Gas Pipeline in Vicinity of Works
 A work permit is required prior to any excavation and/or construction work in the vicinity of the transmission pipeline. A pipeline inspector to be onsite during the proposed works. Refer to AusNet Technical Standard 2607.2 - CONDITIONS FOR WORKS NEAR GAS TRANSMISSION PIPELINES.

WARNING
BEWARE OF UNDERGROUND SERVICES
 The locations of underground services are approximate only and their exact position should be proven on site. No guarantee is given that all existing services are shown. Locate all underground services before commencement of works
DIAL 1100 BEFORE YOU DIG
 www.1100.com.au

ISSUED FOR CONSTRUCTION

REV	DESCRIPTION	DATE	DRN.	APP.	REV	DESCRIPTION	DATE	DRN.	APP.
B	PIT 9 RELOCATED	16.09.21	NI	CD					
A	ISSUED FOR CONSTRUCTION	13.01.21	NI	CD					

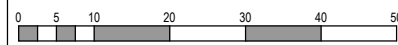

Designed N.VETIC 16.09.2021
 Date
 Drawn L.SUTHERLAND
 Approved C.DOUBLEDAY 16.09.2021
 Date
 PS Number PS826185E



Project Details
TOOLERN WATERS ESTATE
STAGE 12
CITY OF MELTON
 Drawing Title
LAYOUT PLAN
(SHEET 1 OF 2)

Sheet 04 of 31
 Scale
1:500 @ A1
 Project Ref
1600490
 Stage No
12
 Drawing No
010
 Rev
B

FOR CONTINUATION SEE SHEET 1600490-12-010

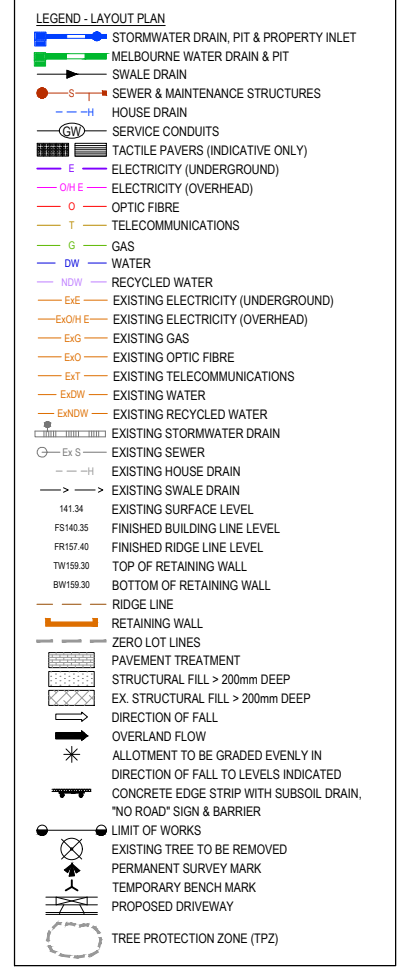
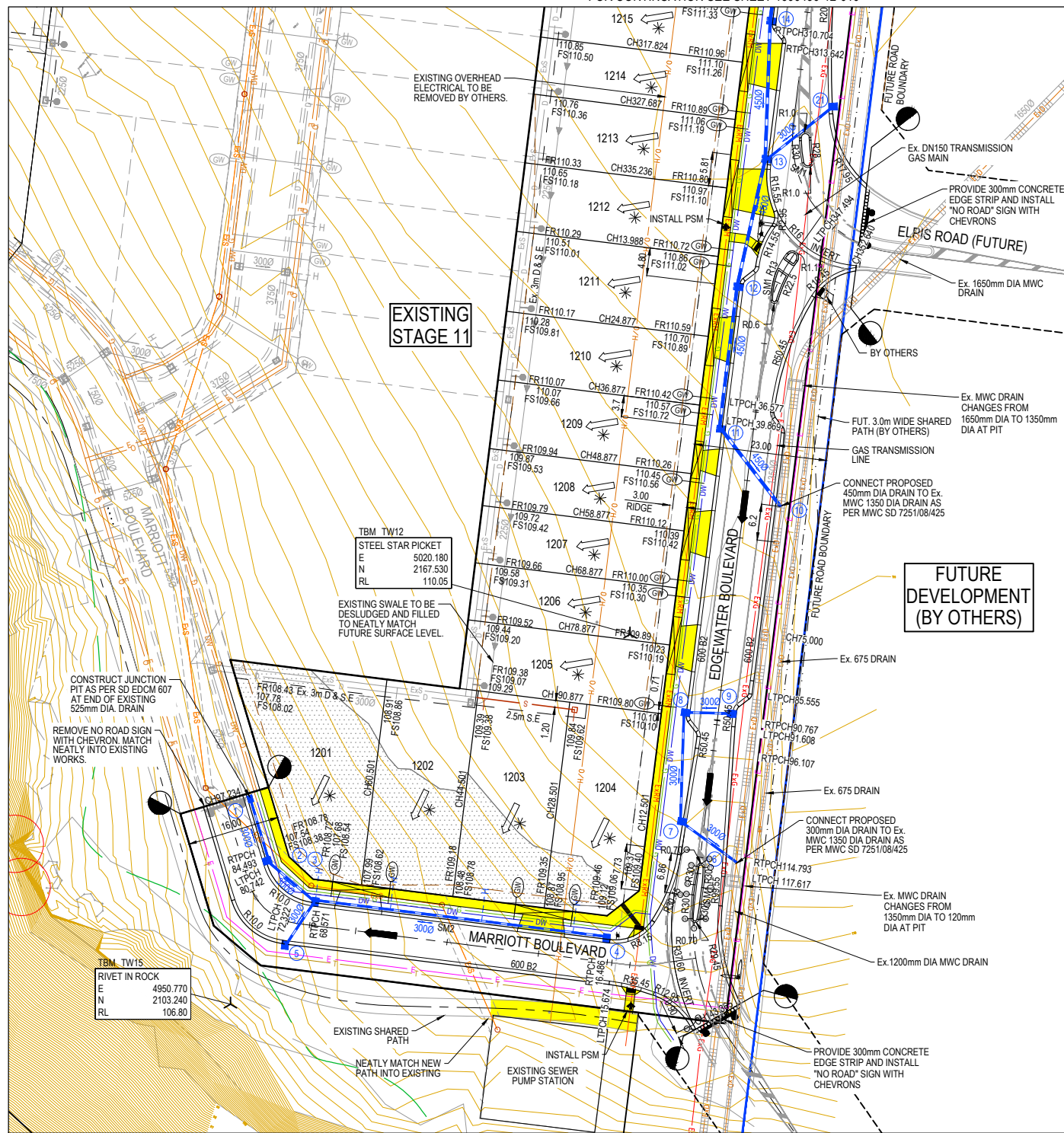

BWARE
AusNet Transmission Gas Pipeline in Vicinity of Works
 A work permit is required prior to any excavation and/or construction work in the vicinity of the transmission pipeline. A pipeline inspector to be onsite during the proposed works. Refer to AusNet Technical Standard 2607.2 - CONDITIONS FOR WORKS NEAR GAS TRANSMISSION PIPELINES.

ROAD LAYOUT TABLE

Road Name	Reserve Width (m)	Road Width (m)			Kerb Type		Verge Width (m)	
		Lip to Lip	Inv to Inv	Back to Back	Nth/West	Sth/East	Nth/West	Sth/East
MARRIOTT BOULEVARD	16.00	6.55	7.30	7.75	600 B2	SM2	4.05	4.20
REES ROAD	17.70	9.70	10.60	10.90	600 B2	600 B2	4.35	1.85
EDGEWATER BOULEVARD	17.70	9.70	10.60	10.90	600 B2	600 B2	4.35	2.45

SERVICE OFFSET TABLE

Location	Gas		ND - Water		Water		Electricity		Telecommunication		Sewer	
	Side	Offset (m)	Side	Offset (m)	Side	Offset (m)	Side	Offset (m)	Side	Offset (m)	Side	Offset (m)
MARRIOTT BOULEVARD	N	2.10	-	-	N	2.60	S	2.60	S	1.90	N	1.00
REES ROAD	W	1.90	W	Ex1.00	W	2.45	E	7.10	E	6.60	-	-
EDGEWATER BOULEVARD	W	1.90	W	Ex1.00	W	2.45	E	5.05	E	4.60	-	-

NOTE: STREET TREES ARE TO BE PLANTED IN THE CENTRE OF ALL NATURE STRIPS

WARNING
BWARE OF UNDERGROUND SERVICES
 The locations of underground services are approximate only and their exact position should be proven on site. No guarantee is given that all existing services are shown. Locate all underground services before commencement of works
DIAL 1100 BEFORE YOU DIG
 www.1100.com.au

ISSUED FOR CONSTRUCTION

© COPYRIGHT All rights reserved
 Beveridge Williams & Co. Pty Ltd has granted a licence to the principle to use this document for its intended purpose.
 No unauthorised copying is permitted

REV	DESCRIPTION	DATE	DRN.	APP.	REV	DESCRIPTION	DATE	DRN.	APP.
B	PIT 9 RELOCATED	16.09.21	NI	CD					
A	ISSUED FOR CONSTRUCTION	13.01.21	NI	CD					



Designed N.VJETIC
 Date 16.09.2021
 Drawn L.SUTHERLAND
 Approved C.DOUBLEDAY
 Date 16.09.2021
 PS Number PS826185E



Project Details
 TOOLERN WATERS ESTATE
 STAGE 12
 CITY OF MELTON
 Drawing Title
 LAYOUT PLAN
 (SHEET 2 OF 2)

Sheet 05 of 31

Scale
 1:500 @ A1

Project Ref	Stage No	Drawing No	Rev
1600490	12	011	B